

Beauty Smart Switches

Installation guide

1. Before installation, separate ③ the coupler' s metal plate from ④ the switch panel (tips: push the plastic buckle when separating and pull out)
2. Rip away 5mm from the Twisted Pair cable and insert into KNX socket, and insert the KNX socket on the ③ the coupler.
3. Fix ③ the metal plate and coupler into the ② install box, adjust ③ the metal plate position. Using two M4*30 screws (please using enclosed screws because other screws maybe get higher caps) to fix the metal plate.
4. Push ④ the switch panel into ③ the metal plate for initial installation test. Design and debug the application after initial test installation to complete installation.

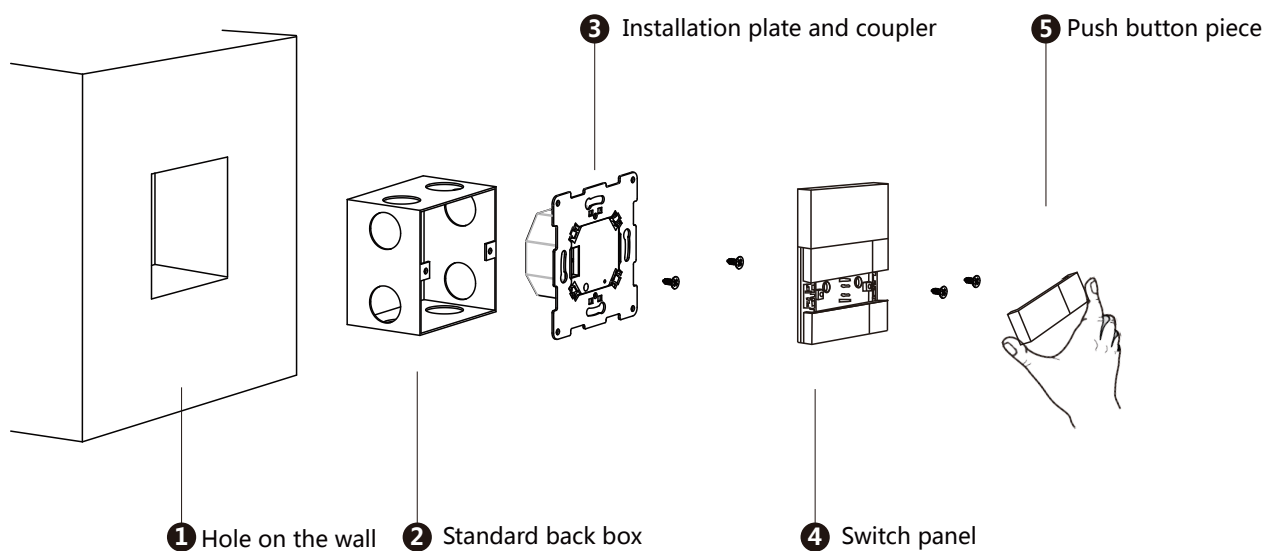

Note: If the switch panel need thief protection, please use anti-thief screw. The procedures are: using a slim plastic item to prize up the bush button from the side of the panel. Remove the stainless steel cover. Screw on a M3*8 round cap screw. Insert back the stainless cover and then push the button back.

Technical Details

| | | | | | | | | | | |
|--------------|------------------|---|-------------------|-----------|------------------------------------|---|--------------|----|-------|---|
| Power Supply | Bus voltage | 21-30 DC from EIB | Installation | Method | Standard 80*80mm/ 86*86mm wall box | | | | | |
| | Electric Current | < 12mA | | Operating | -5°C...+45°C | | | | | |
| | Bus low power | < 360mW | | Storage | -25°C...+55°C | | | | | |
| Connecting | EIB/KNX | Connection Terminal (Diameter 0.8mm ²) | Temperature Range | Colour | Golden | G | Silvery | S | Black | B |
| | | | | | White | W | Dark Silvery | DS | | |

! Important

- Installation and debugging can be only operated by qualified electrician. In the process of planning and implementation of electrical installation, the relevant standards, directives, regulations and instructions must be strictly enforced.
- To avoid the device being dirty and damaged during the process of transport, storage and using.
- Do not run the device beyond the specified technical standards (e.g. temperature range).
- When cleaning the device, only use dry cleaning cloth. Never use an alkaline agent or corrosive solvents.